



OUR_x PRESCRIPTION FOR YOUR SUCCESS



M&M India Limited
 Subsidiary M&M India Cosmopolitan Limited
 CIN: U40100GJ2007PLC044491

© Preeti Saha Towers, Tower-B,
 401 Floor, Golf Course Road, Sector-66,
 Gurgaon - 122002, India

Saha Sahay/ CRM Cell
 The Esplanade, Golf Course Road (East),
 Sector-66, Gurgaon - 122002, India

Site:
 M&M Cosmopolitan,
 Golf Course Road, Sector-66,
 Gurgaon - 122002, India

- ☎ +91 124 4712000
- ☎ +91 124 4713000
- ☎ 1800 122 0339
- ☎ 98901 30269
- 🌐 www.mmmindia.com
- 🌐 www.mmmcosmopolitan.com



WHERE HEALTH
MEETS
CONVENIENCE









M3M Cosmeplus is conceptualized to provide a unique health experience which has never been seen before in India, a one stop destination for healthcare, where doctors, pathlabs and pharmacies make sure that all the medical facilities are available to their patients under one roof.

Cosmeplus is created with a belief that a total healthcare experience should be convenient and comfortable to the core, and that is exactly what we will be delivering.



COSMOPLUS ADVANTAGES

MDM CosmoPlus will be an excellent business opportunity in the medical field, with all the requisite facilities like path labs, pharmacies etc. under one roof.

-  Located at Sector-66, a center of high density and up-market area, surrounded by over 1.3 lacs residential apartments, translating to over 5 lacs high networth individuals
-  Close proximity to over 150 upcoming projects in the area including our projects like the MDM Golf Estate, MDM Polo Suites, MDM Cosmopolitan, MDM Merlin, MDM Escala and MDM Urbana
-  Excellent business opportunity by MDM to promote your practice through advertisements and publicity for the centre, direct mailers, letters, cards, digital media, signages etc.
-  The medical practitioners at CosmoPlus will have access to all the MDM customers (database) including- MDM Golf Estate, MDM Polo suites, MDM Merlin, MDM Woodshire, MDM Urbana, MDM Cosmopolitan, MDM Escala and other new projects as well as over 5 lacs HNIs in the catchment area
-  CosmoPlus will be replete with pathological labs, chemists and doctors chambers in the same complex
-  A unique privilege card will be given to customers, which will show the patients history through a pre-determined code
-  High quality anti-bacterial and anti-viral materials will be used assuring a safe and hygienic environment for patients
-  Medical Concierge service will be available at the centre



EXCLUSIVE FEATURES CUSTOMISED FOR DOCTORS

- Exclusive units for medical practitioners
- Space for diagnostics labs and pharmacy on the lower floor
- Reception and appointment desk at the ground level
- Fully furnished suites, with 2 design options. Finished with flooring, false ceiling and cabins with wash basin
- Dedicated service elevator
- Public toilets on each floor
- Modern and well-designed lobby
- Visitor parking for customers
- Air conditioned with ducted split units
- Separate electricity metering for each unit
- Suitable for a wide range of conventional and alternative medicine



M3M
COSMOPLUS
CUSTOM
DESIGNED
FOR YOU

Suitable for a wide range of conventional and alternative medicine practitioners, diagnostic and pathology laboratories and chemists.





M3M COSMOPLUS
DESIGNED WITH
TOTAL PATIENT
EXPERIENCE IN
MIND



M&M
COSMOPOLITAN
STYLISH RETAIL & COMMERCIAL HUB

M&M Cosmopolitan is a "Los Angeles-like" design of consumer friendly retail and office space that resemble "Manhattan". It will provide an enigmatic experience with open spaces, double height retail outlets, skybridges, exotic water fountains, green trees and food-courts on the rooftop. M&M Cosmopolitan is based on a new age and a trend-setting structure that will accommodate a mix format development. It will feature sophisticated design elements, exclusive retail promenade, richly landscaped, providing a retreat for the patrons.

Our planning exemplifies our principles of creating the perfect blend of art and robustness in a structure. Cosmopolitan embodies a perfect urban and sustainable building with smart growth principles.

There will be business and there will be pleasure!
This will surely lend itself to a very pleasant "unlike-medical" environment for patients and families.

- Each Medical Suite shall comprise of an entrance waiting lounge, reception area, a doctor's chamber or chambers with built in wash basin, storage counter and powder room.
- These elegantly finished suites are equipped with common facilities such as pantry and a public toilet block.
- Parking facilities shall be shared-parking and only right-to park may be given so as to keep a substantial parking available for visitors.
- An elegant entrance lobby with occupants' direction signage and an appointment desk.



M3M COSMOPLUS LOCATION ADVANTAGE

- 150** Over 150 projects in the catchment area
- 1.30 Lacs** Over 1.3 lac residential apartments
- 5.0 Lacs** Translating to over 50 lacs high networth audience!

CIRCLE OF OPPORTUNITY



MAP NOT TO SCALE

SITE PLAN

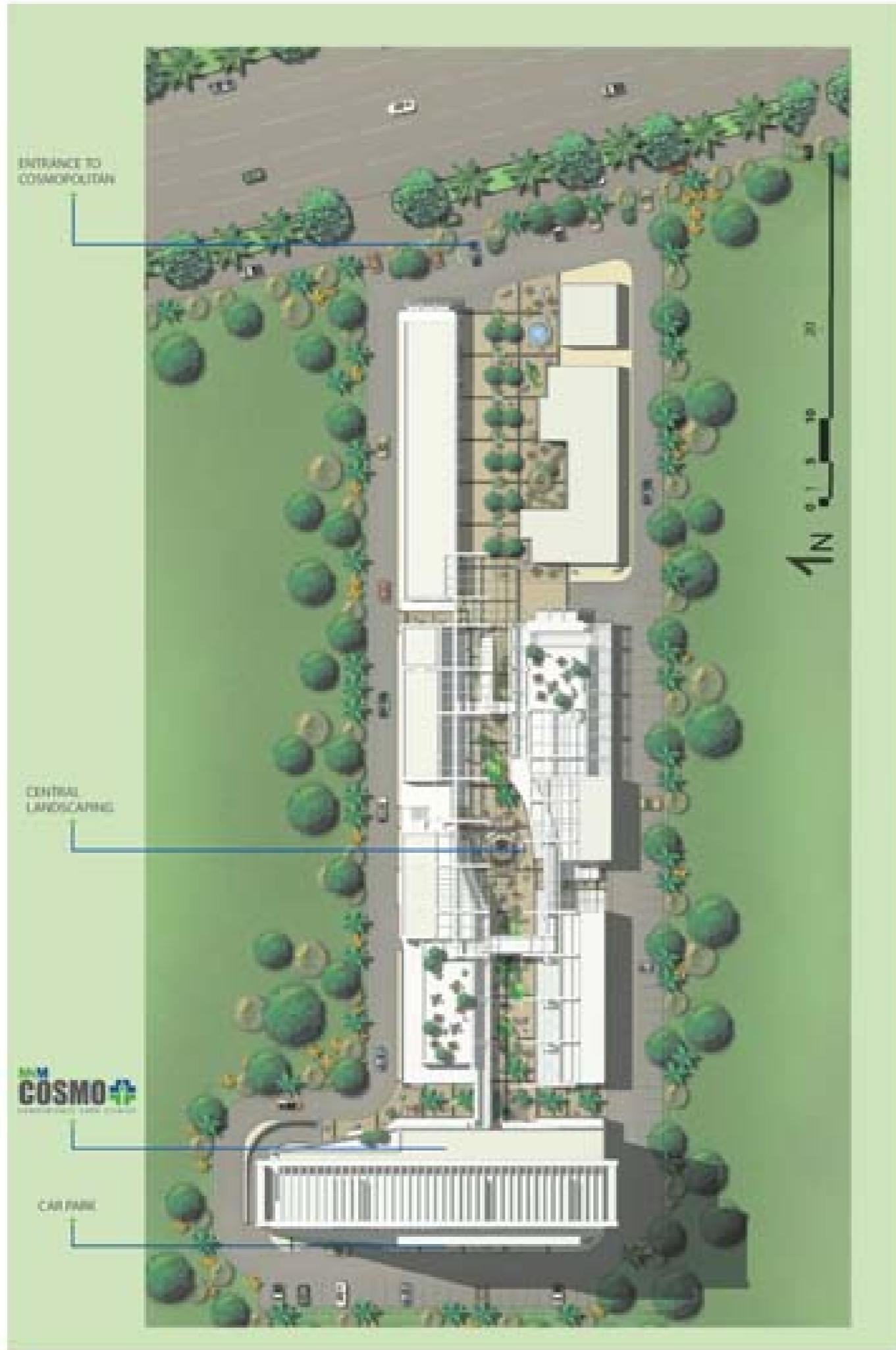

FLOOR PLAN - 7TH FLOOR

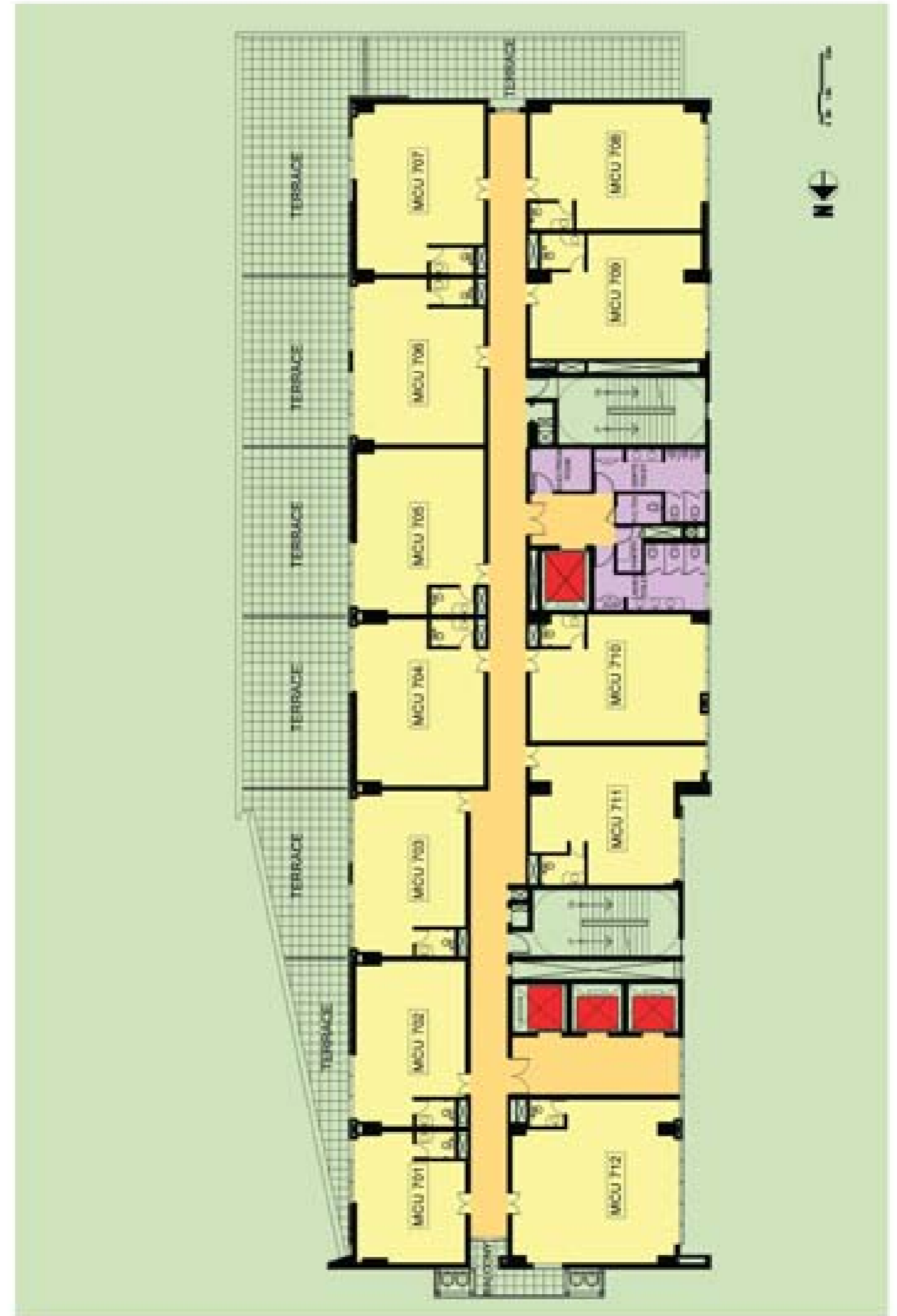

FLOOR PLAN - 10TH FLOOR



FLOOR PLAN - 8TH, 9TH, 11TH & 12TH FLOOR





'MAGNIFICENCE IN THE TRINITY OF MEN, MATERIALS & MONEY'.

M3M India Limited - A Class Apart!

- Developing nearly 10 million sq.mtrs. (one crore sq. ft.) spread over more than 40 hectares (100+ acres) in Gurgaon's most prime location in sector 45, 46, 47 and 48.
- Committed over Rs. 4,000/- crores towards construction.
- Hired the most reputed Indian and global architects, designers and construction partners.
- Construction at all projects making rapid progress.

The World Of Group M3m



The future of luxury-living is here. M3M Life is a venture that will develop high-end housing projects all over the country.

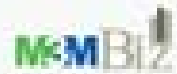

M3M Biz is here to revolutionise shopping and office spaces. This part of the Company specialises in bringing exclusive commercial centres to life. It is here to take on the responsibility of changing our outlook towards office and retail spaces in the near future.



M3M Joy proposes to create an ideal world of entertainment and hospitality. It will spearhead the Company's journey into innovative projects by bringing world-class hotels, serviced apartments and more to life.



M3M Zone is M3M's own "Silicon Valley". This part of the Company will be responsible for bringing in IT companies and SEZs, to put this area amidst intelligent surroundings.



M3M Learn is a revolutionary effort by M3M India Ltd. that will specialise in bringing up the best institutions affiliated with top universities worldwide. It will be responsible for delivering the best in education.



M3M India Ltd. is expanding internationally, forging life-long, mutually beneficial ties. This is in line with the Group's long-term ambitious growth strategy to mark its presence globally. The Group already has a marketing presence in the USA, UK and the Middle-East.

CONSTRUCTION TEAM
CCCL

ARCHITECTURAL TEAM
RSA+R20+DESIGN

DESIGN TEAM
RSP DESIGN



COSMOPLUS PRIVILEGE CARD

At CosmoPlus we have ensured nothing but the best for you with our privilege cards. These privilege cards will be given to all MDM customers moreover the card will keep a record of the patient's medical history. Each of these cards will have unique benefits such as discounts and different offers to avail. With a proposition so alluring footfalls are bound to increase manifold and stay.

